

‘THE
WORLD
BEYOND MY
WINDOW’





How is your life influenced
by different places?

How is your life connected to
different places?



What geographical processes
create and shape places?

What is the human and physical
geography of these places?

**THIS WEEK'S SUPER CURRICULUM THEME IS
DESIGNED TO GET YOU THINKING ABOUT
GEOGRAPHICAL IDEAS IN THE WIDER WORLD.**

'THE WORLD BEYOND MY WINDOW'

I would like to see if we have any budding thinkers amongst us.

Please create your own ESRI story map about the coronavirus pandemic.

- We are interested in entries that explore the human and physical geography of places that exist beyond a young person's window, be it locally or further afield. You could include some of the following and/or your own, individual ideas:
- How is your life connected to and influenced by other areas? How has lockdown affected your lives, the economy and society. Has anything change for the better? Is there global trends which have been accelerated? Is societal inequality increasing? How has the environment been affected? Lots to think about.
- Also, how are you connected physically, emotionally or digitally?
- We also want to understand how geographical processes in the physical and human worlds have created these places and might be changing them.
- What maps/ images can you include?
- What graphs can you include?

ESRI STORY MAP

What is a story map?

- Esri Story Maps are web applications that let authors combine beautiful maps with narrative text, striking images, and multimedia, including video. The applications are designed to be attractive and usable by anyone, which makes them great for education and outreach, either to the general public or to a specific audience.
- Esri Story Maps are built into **ArcGIS**, the world's leading mapping and GIS platform. To start creating story maps, you need to create a free **ArcGIS account**.
- [ArcGIS Online](https://storymaps.arcgis.com/?) and sign in for story maps here: <https://storymaps.arcgis.com/?>.
- <https://storymaps-classic.arcgis.com/en/faq/#question1> for help if stuck.

Esri Story Maps are a simple yet powerful way to inform, engage, and inspire people with any story you want to tell that involves maps, places, locations, or geography. They make it easy for you to harness the power of maps to tell your story.

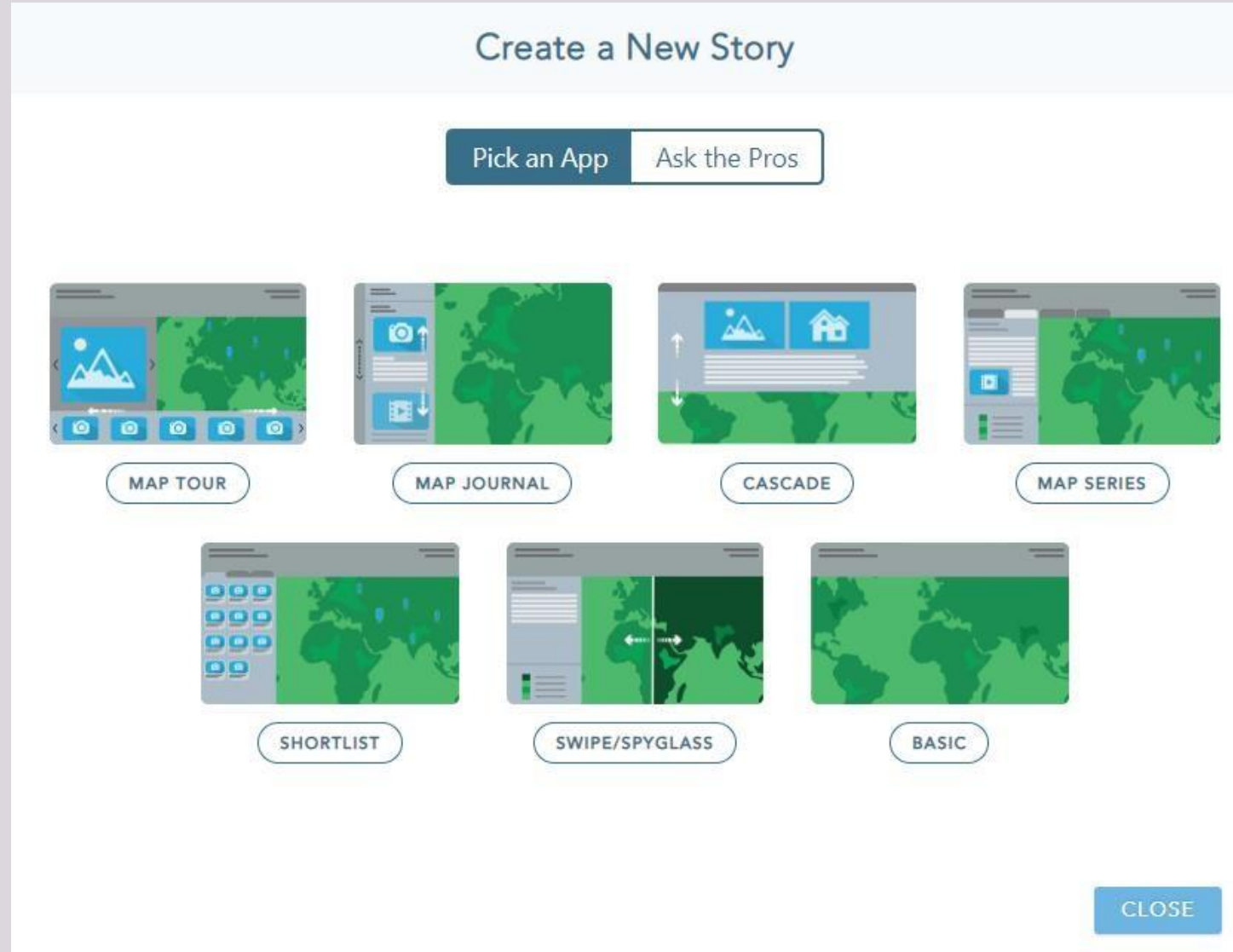



RGS YOUNG GEOGRAPHER OF THE YEAR COMPETITION 2020!



This year's Young Geographer of the Year competition gives you the chance to explore the potential that Geography holds! Although we are confined to our homes right now, we would like you to explore your wider geographical horizons. So the title this year is

‘the world beyond my window’

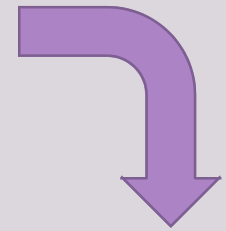

**The deadline for all entries is
Friday 19th March 2021 at 9am**

To enter you need to produce an ESRI storymap of no more than 1500 words. This can be hand-made (then sent electronically via a scanned copy or photograph) or using PowerPoint, Word, Publisher or PDF etc.



All entries should address this year's theme and must meet the following criteria:

- Excellent attention to spelling, punctuation and grammar
- Use of accurate geographical terminology
- Clearly labelled and appropriately acknowledged sources, including diagrams, charts, maps or images
- Accurate use of symbols, scales and keys,
- Original and independently produced—class sets of identical entries will not be accepted or entries which have copied information from other sources, such as the internet
- If produced electronically, please use a minimum font size of point 10



You will consider ideas such as population, place, space, environment, interconnection, sustainability, scale and change.

- On the next slide are a few ideas to look at
- 

Resources

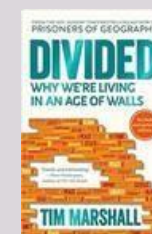
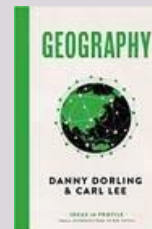
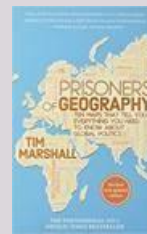

[Overheard – National Geographic Podcast](#)
[Science Weekly – The Guardian Podcast](#)
[Ask the geographer Podcasts](#)
[The Development Podcast – World Bank](#)
[The World Economic Forum Podcasts](#)

[Planet Money – The economy explained](#)
[RGS Online Lectures](#)
[BBC Costing the Earth](#)
[BBC The Documentary Podcast](#)
[Living Planet Podcast](#)



[World economic forum videos](#)
[Royal Geographical Society Youtube](#)
[iPlayer Science and Nature Playlist](#)
[iPlayer Climate Change Playlist](#)
[BBC Earth](#)

[iPlayer Earth from Space](#)
[iPlayer Stacey Dooley on BBC Three](#)
[iPlayer Race Across the World](#)
[iPlayer Africa with Ade Adepitan](#)
[iPlayer Fashion Conscious](#)



COMPETITION TIME!

Prize available for 1st place!

Honourable mentions for 2nd and 3rd place



RGS YOUNG GEOGRAPHER OF THE YEAR COMPETITION 2020!



Key Stage 5 Criteria (pupils aged 16-18)

Describe and discuss **multiple** geographical ideas
Demonstrate a **strong** use of annotated images, diagrams, charts or maps.



Use your newly acquired knowledge to create an ESRI storymap which outlines your ideas about what is happening beyond your window.



Submit your leaflet to the following email address by the closing date



Email:
[Competitions@gordons.sc
hool](mailto:Competitions@gordons.school)



When you email, please use the subject heading 'KS5 Week 7 - 'The world beyond my window''



Closing date: **19th March 2021**



Winners will be announced via weekly Schoolcomms

**'THE WORLD
BEYOND MY
WINDOW'**